

Courses & distances
down the Allegany
River from the Hickory

- S. 25. E. 46 ✓
- S. 40. E. 20 ✓
- S. 7. E. 40 ✓
- S. 11. W. 11 ✓
- S. 2. E. 30 ✓
- S. 33. W. 31 ✓
- S. 63. W. 26 ✓
- S. 43. W. 119 ✓
- S. 32. W. 26 Lyr ✓
- S. 17. W. 36 ✓
- South 56 ✓
- S. 24. E. 32 ✓
- S. 52. E. 24 ✓
- East 38 ✓
- N. 76. E. 68 ✓
- N. 67. E. 142 B.K. ✓
- S. 52. E. 100 ✓
- S. 43. E. 81 ✓
- S. 17. E. 40 Hemlock ✓

966

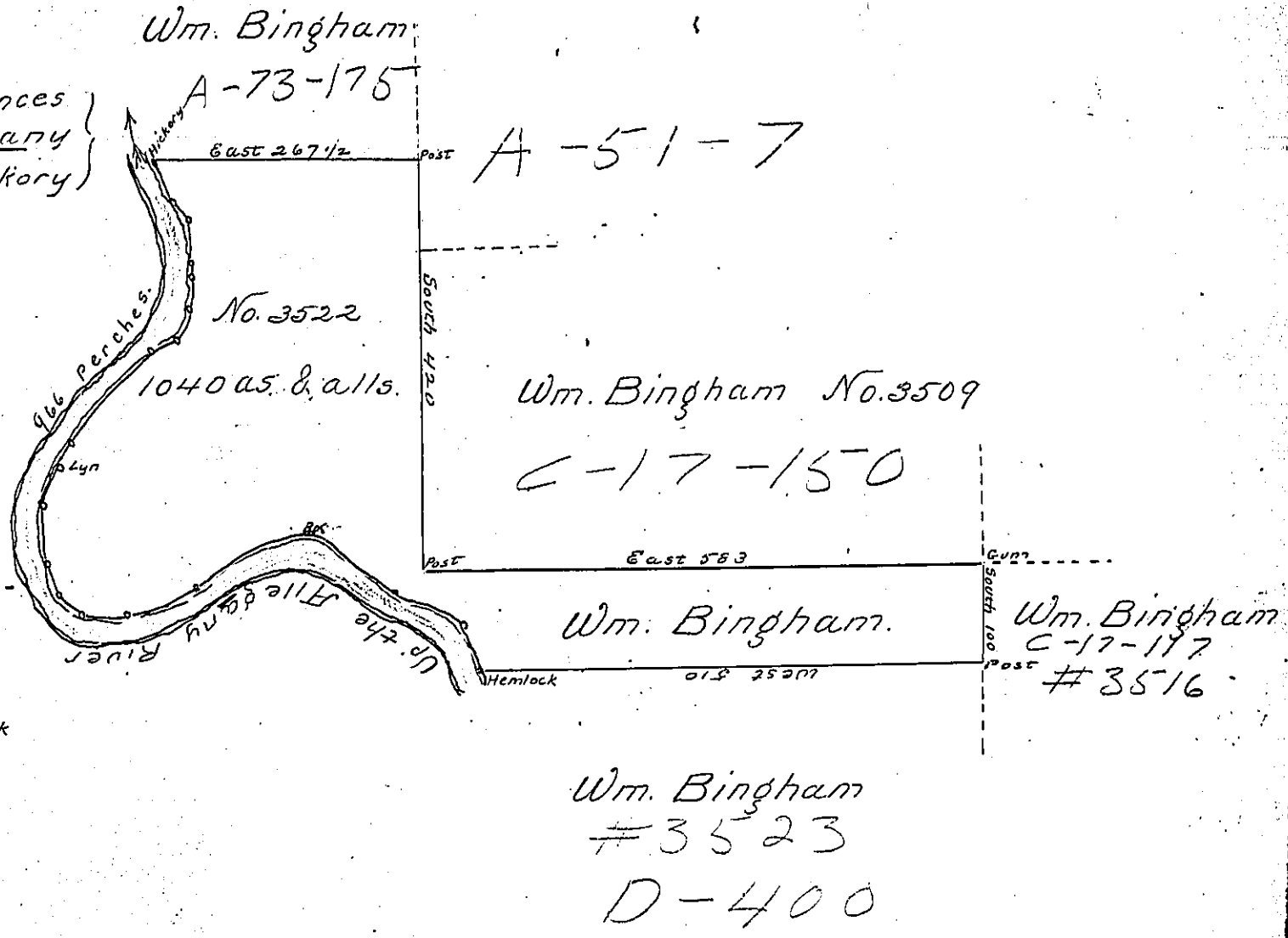

In pursuance of a Warrant No. 3522

dated the 14th day of December ¹⁷⁹² Surveyed the
4th day of August 1794 To William Bingham the
above described Tract of Land situate on the main
Allegany River in the late purchase Northum-
berland County in District No. 6 containing one
thousand & forty acres & allowance of six percent.

p.

Jno. Brodhead Lt. S.

Daniel Brodhead Esqr.
Surveyor General

IN TESTIMONY that the above is a copy of the original remaining on file in
the Department of Internal Affairs of Pennsylvania, made
conformably to an Act of Assembly approved the 16th day of
February, 1833, I have hereunto set my Hand and caused
the Seal of said Department to be affixed at Harrisburg,
this sixth day of August 1901

James W. Latta
Secretary of Internal Affairs.